

BMM – SVINGBLOKKE

BMM – SWING BLOCKS

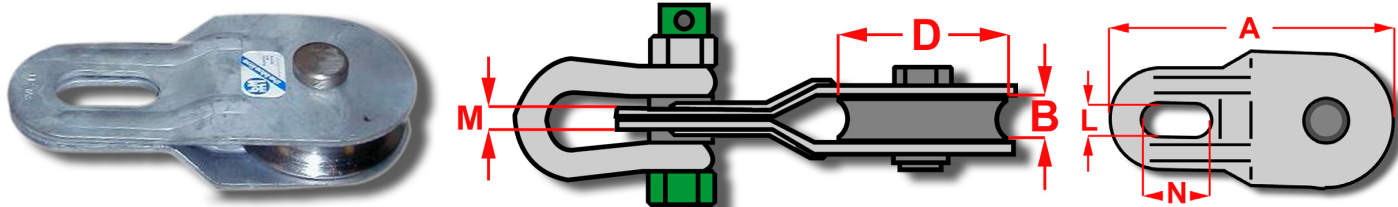

Best. nr.	A	B	D	L	M	N	SWL	Brudstyrke	Vægt/stk.
Order no.	A	B	D	L	M	N	SWL	Breaking load	Weight/Pcs
	mm	mm	mm	mm	mm	mm	Ton 1:5	Ton	Kg.
KSW 1-N	190	22	80	24	9	48	1,0	5,0	1,0
KSW 1-1	190	22	80	24	9	48	1,0	5,0	1,6
KSW 1-0	190	22	80	24	9	48	1,0	5,0	1,6
KSW 1-1ESS	190	22	80	24	9	48	1,0	5,0	1,6
KSW 2-N	255	24	110	28	9	56	2,0	10,0	1,9
KSW 2-1	255	24	110	28	9	56	2,0	10,0	2,9
KSW 2-0	255	24	110	28	9	56	2,0	10,0	3,0
KSW 2-1ESS	255	24	110	28	9	56	2,0	10,0	2,9
KSW 3-N	350	28	150	42	12	60	3,0	15,0	4,0
KSW 3-1	350	28	150	42	12	60	3,0	15,0	6,3
KSW 3-0	350	28	150	42	12	60	3,0	15,0	6,4

Skiver / Sheaves



Article	B	D	R	S	Weight	Article	B	D	S	Weight
	mm	mm	mm	mm	Kg.		mm	mm	mm	Kg.
SKSW 1-N	22	80		17	0,15	SKSW 1-0	22	80	20	0,75
SKSW 1-1	22	80	40	17	0,60	SKSW 2-0	24	110	25	1,30
SKSW 1-1ss	22	80	40	17	0,60					
SKSW 2-N	24	110		20	0,25					
SKSW 2-1	24	110	47	20	0,25					

Reslag passer til fig. sjækler 1/2" & 5/8"

Mountings fit shackles 1/2" & 5/8"

Bolte / Bolts

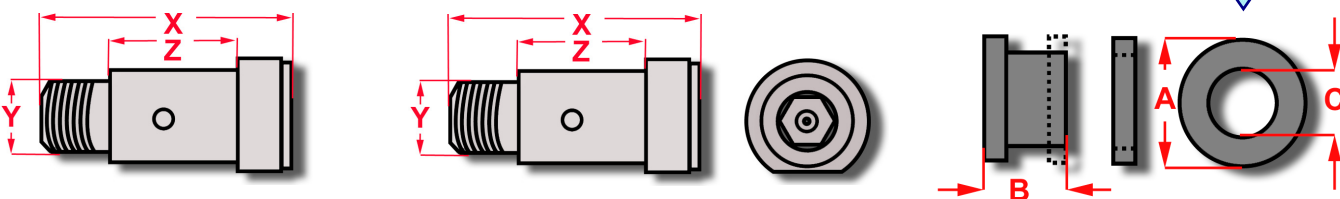

Order no.	X	Y	Z	Weight	Order no.	X	Y	Z	Weight	Order no.	A	B	C	Weigh
	mm	mm	mm	Kg.		mm	mm	mm	Kg.		mm	mm	mm	Kg.
PKSW 1-N	50	17	28	0,10	PKSW 1-0	57	20	28	0,15	KSW1-B	32	21	17,5	0,1
PKSW 1-1	50	17	28	0,10	PKSW 2-0	61	25	30	0,25	KSW2-B	40	28	20,5	0,2
PKSW 1-1Ess	50	17	28	0,10										
PKSW 2-N	52	20	30	0,15										
PKSW 2-1	52	20	30	0,15										