

**KASTBLOKKE, GALVANISEREREDE**  
**BMM – SNATCH BLOCKS, GALVANISED**

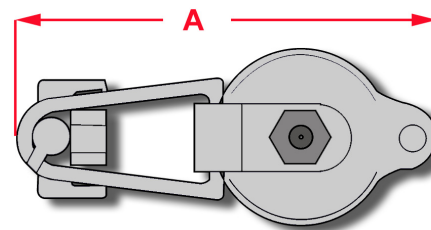
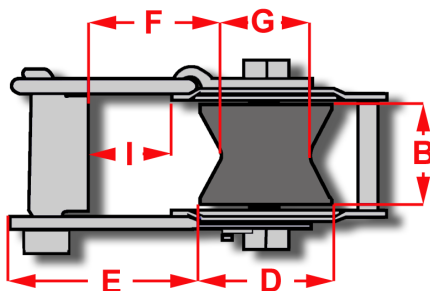
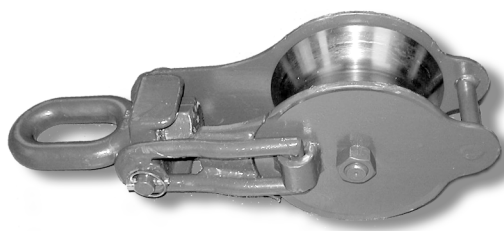

| Best. nr.         | A   | B   | D   | E  | F   | G   | I  | SWL     | Brudstyrke    | Vægt/stk.  |
|-------------------|-----|-----|-----|----|-----|-----|----|---------|---------------|------------|
| Order no.         | A   | B   | D   | E  | F   | G   | I  | SWL     | Breaking load | Weight/Pcs |
|                   | mm  | mm  | mm  | mm | mm  | mm  | mm | Ton 1:5 | Ton           | Kg.        |
| KS 110 - ☒EG      | 255 | 85  | 110 | 68 | 85  | 70  | 45 | 3,0     | 15,0          | 10,8       |
| KS 150 - ☒EG      | 330 | 85  | 150 | 75 | 85  | 110 | 55 | 5,0     | 25,0          | 20,0       |
| KS 215 - ☒EGP (*) | 425 | 100 | 215 | 95 | 100 | 170 | 63 | 8,0     | 40,0          | 39,5       |

(\*)Leveres med split ved lukkemekanismen / Available only with split at locking device

**Blokkene skal bestilles med: / Blocks must be ordered with:**

- Bronzelejer / Bronze bushings) Smørbare / Greaseable**  **1 Kugleleje smørbare / Ball bearing greaseable**

**Ekstra tillæg / Extra add on services**

- C Testede med certifikat / Tested included certificate**  **P Split / Split ks150/215**

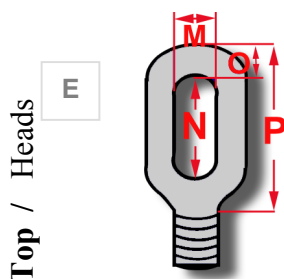

Skiver / Sheaves

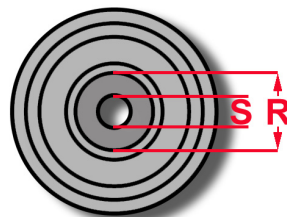
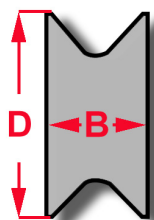

| Order no.    | M  | N   | O  | P   | Order no. | B   | D   | R  | S  | Weight |
|--------------|----|-----|----|-----|-----------|-----|-----|----|----|--------|
| KS 110 - ☒☒  | 33 | 82  | 24 | 134 | SKS 110-1 | 85  | 110 | 62 | 25 | 3,60   |
| KS 150 - ☒☒  | 40 | 95  | 28 | 153 | SKS 150-1 | 85  | 150 | 62 | 25 | 8,10   |
| KS 215 - ☒☒P | 54 | 110 | 35 | 181 | SKS 215-1 | 100 | 215 | 80 | 35 | 18,30  |

**Bronzeleje / Bronze bushing**

**Kugleleje / Ball bearing**

**Bronzeleje / Bronze bushing**

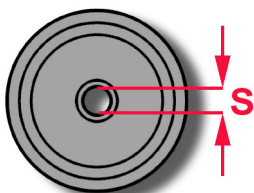
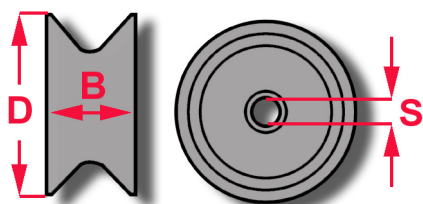

Bolte / Bolts

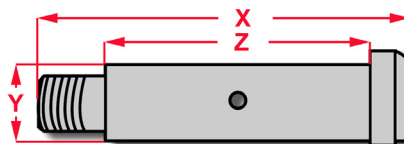

| Order no. | B   | D   | S  | Weight | Order no. | X   | Y  | Z   | Weight | Order no. | X   | Y  | Z   | Weight |
|-----------|-----|-----|----|--------|-----------|-----|----|-----|--------|-----------|-----|----|-----|--------|
| SKS 110-0 | 85  | 110 | 25 | 3,80   | PKS 110-1 | 144 | 25 | 115 | 0,60   | PKS 110-0 | 144 | 25 | 115 | 0,60   |
| SKS 150-0 | 85  | 150 | 25 | 8,20   | PKS 150-1 | 154 | 25 | 122 | 0,70   | PKS 150-0 | 154 | 25 | 122 | 0,70   |
| SKS 215-0 | 100 | 215 | 35 | 18,50  | PKS 215-1 | 158 | 35 | 117 | 1,30   | PKS 215-0 | 158 | 35 | 117 | 1,30   |

