

## BMM – TAKLEBLOKKE, BLÅMALEDE

BMM – TACKLE BLOCKS, BLUE PAINTED

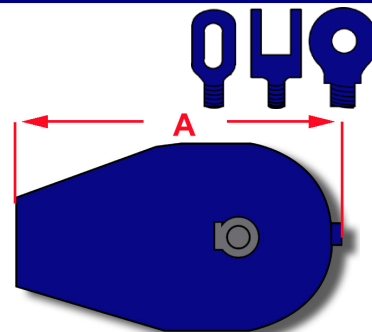
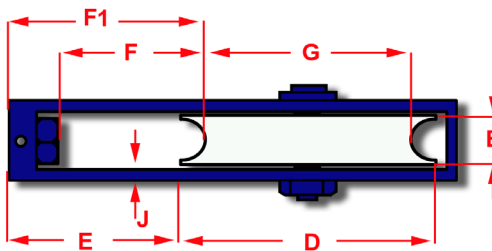
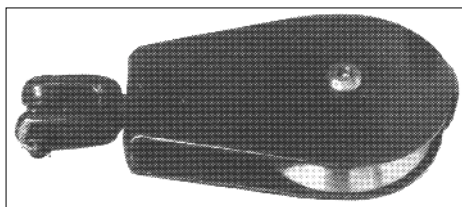

Best. nr.	A	B	D	E	F	F <sub>1</sub>	G	J	SWL	Brudstyrke	Vægt/stk.
Order no.	A	B	D	E	F	F <sub>1</sub>	G	J	SWL	Breaking load	Weight/Pcs
	mm	mm	mm	mm	mm	mm	mm	mm	Ton 1:5	Ton	Kg.
KT 230 – 1☒	405	57	230	150	110	168	195	8	6,0	30,0	26,0
KT 300 – 1☒	480	66	300	155	100	175	260	10	9,0	45,0	55,0

## BMM – TAKLEBLOKKE, BLÅMALEDE

BMM – TACKLE BLOCKS, BLUE PAINTED

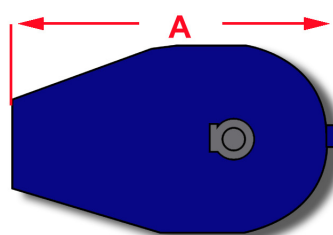
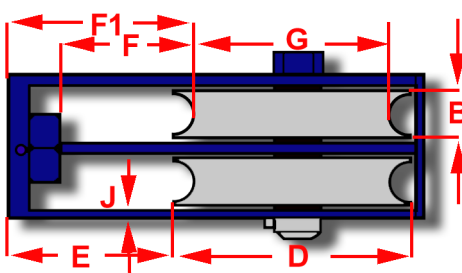
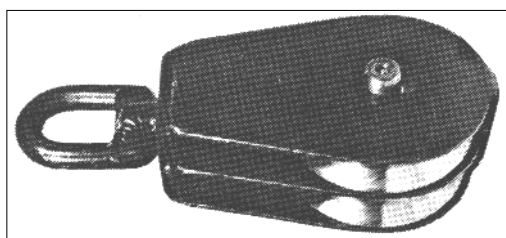

Best. nr.	A	B	D	E	F	F <sub>1</sub>	G	J	SWL	Brudstyrke	Vægt/stk.
Order no.	A	B	D	E	F	F <sub>1</sub>	G	J	SWL	Breaking load	Weight/Pcs
	mm	mm	mm	mm	mm	mm	mm	mm	Ton 1:5	Ton	Kg.
KT 230D – 1☒	405	57	230	150	110	168	195	8	9,0	45,0	54,0
KT 300D – 1☒	480	66	300	155	100	175	260	10	11,0	55,0	86,0

## BMM – TAKLEBLOKKE, BLÅMALEDE

BMM – TACKLE BLOCKS, BLUE PAINTED

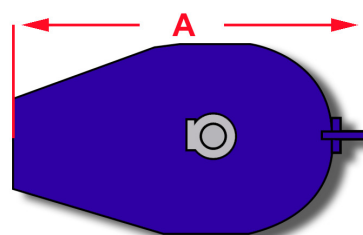
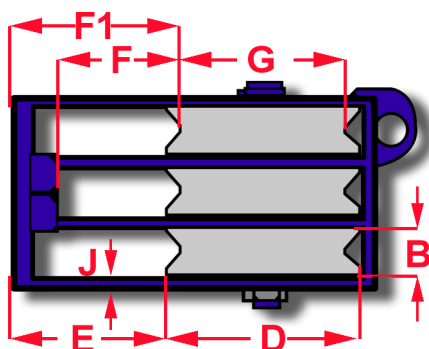
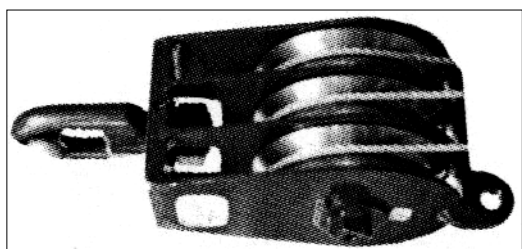

Best. Nr.	A	B	D	E	F	F <sub>1</sub>	G	J	SWL	Brudstyrke	Vægt/stk.
Order no.	A	B	D	E	F	F <sub>1</sub>	G	J	SWL	Breaking load	Weight/Pcs
	mm	mm	mm	mm	mm	mm	mm	mm	Ton 1:5	Ton	Kg.
KT 230T – 1☒	405	57	230	150	110	168	195	8	9,0	45,0	76,0
KT 300T – 1☒	480	66	300	155	100	175	260	10	11,0	55,0	122,0

Takle blokke serie KT230/300 side 1/2 / Tackle blocks type KT230/300 page 1/2