

LUKKEDE ENDE TERMINALER FOR VALSE-/ PRESSEMASKINER

CLOSED END TERMINALS FOR ROLLER-/POWER PRESSES

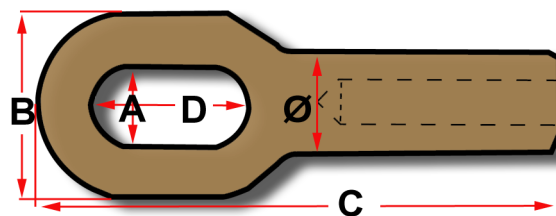

Best. nr.	For wire	A	B	C	D	Ø	Størrelse	Bakker	Vægt
Order no.	wire size	A	B	C	D	Ø	Size	Dies	Weight
	mm	mm	mm	mm	mm	mm	mm	Talurit	Kg / pcs
NE 08 *	8	20	42	130	41	25,7	Small	T11-UM12	0,40
NE 10 *	10	20	42	130	41	25,7	Small	T11-UM12	0,40
NE 12 *	12	20	42	130	41	25,7	Small	T11-UM12	0,40
NE14-28*	14	36	75	200	55	28,0	Medium	T11-UM12	1,10
NE 14 **	14	36	75	200	55	32,0	Medium	T14-UM16	1,20
NE 16 **	16	36	75	200	55	32,0	Medium	T14-UM16	1,15
NE 18 **	18	36	75	200	55	32,0	Medium	T14-UM16	1,10
NE 20 **	20	43	87	230	56	40,5	Large	T18-UM20	2,05
NE 22 **	22	43	87	230	56	40,5	Large	T18-UM20	1,95
NE 24 **	24	43	87	230	56	40,5	Large	T18-UM20	1,85
NE 26 ***	26	48	90	241	65	51,5	X-large	T22-UM24	3,60
NE 28 ***	28	48	90	241	65	51,5	X-large	T22-UM24	3,50
NE 30 ***	30	48	90	241	65	51,5	X-large	T22-UM24	3,40

*150 TONS TALURIT **/300 TONS TALURIT ***/600 TONS TALURIT

WIRELÅSE - DIN 741 TYPE - GALV.

WIRE ROPE GRIPS - DIN 741 TYPE - GALV.

Best. nr.	Størrelse		For wire	Antal pr. mont.	Pr. ks.	Vægt/100
Order no.	Size		Wire size	Qty. Per. Mount.	Qty/box	Weight/100
	mm	Inch	mm	PCs.	PCs.	Kg
1220103	3	1/8	3,5	3	2000	0,72
1220105	5	3/16	4,0 - 5,0	3	2000	1,14
1220106	6	1/4	5,5 - 6,5	3	1500	1,40
1220108	8	5/16	7,0 - 8,0	3	1000	2,35
1220110	10	3/8	8,5 - 9,5	3	500	4,90
1220111	11	7/16	10,0 - 11,0	3	500	6,20
1220113	13	1/2	12,0 - 13,0	3	300	10,70
1220114	14	9/16	14,0 - 15,0	3	200	12,00
1220116	16	5/8	16,0 - 17,0	5	200	18,20
1220119	19	3/4	18,0 - 19,0	5	150	22,75
1220122	22	7/8	20,0 - 23,0	5	100	28,10
1220126	25	1	24,0 - 26,0	5	50	39,00
1220130	28	1 1/8	27,0 - 30,0	5	20	62,00
1220134	32	1 1/4	31,0 - 33,0	7	1	72,00
1220140	38	1 1/2	34,0 - 40,0	7	1	89,00

