

G-KROG - BLÅMALEDE

G-HOOKS - BLUE PAINTED

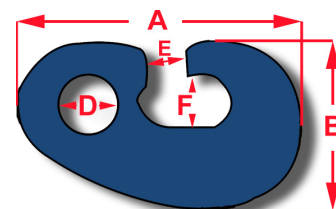

Best. nr.	A	B	Tykkelse	D	E	F	Swl	Brudlast	Vægt
Order no.	A	B	Thickness	D	E	F	Swl	Break load	Weight
	mm	mm	mm	mm	mm	mm	Tons 1:5	Tons	Kg.
EG01	88	55	12	17	10,5	14	1,0	5,0	0,36
EG02	107	66	16	20	13,0	19	1,5	7,5	0,60
EG03	123	77	20	26	15,0	22	3,2	16,0	0,90
EG04	150	95	25	32	20,0	26	4,4	22,0	1,80
EG05	180	115	30	38	23,0	31	5,6	28,0	3,10
EG06	195	126	35	41	25,0	34	10,0	50,0	4,40
EG07	230	140	40	47	28,0	38	12,5	62,5	6,60

PRESSEDE RINGE - BLÅMALEDE

RECESSED LINKS - BLUE PAINTED

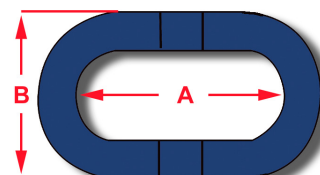

Best. nr.	Diameter	A	B	Tyk. på presning	Swl	Brudlast	Vægt
Order no.	Diameter	A	B	Thickness of press	Swl	Break load	Weight
	mm	mm	mm	mm	Tons 1:5	Tons	Kg.
ER01	12	70	30	10	1,0	5,0	0,20
ER02	16	85	35	12	1,5	7,5	0,40
ER03	20	110	45	14	3,2	16,0	0,90
ER04	25	130	50	18	4,4	22,0	1,50
ER05	28	150	60	21	5,6	28,0	2,10
ER06	32	150	60	23	10,0	50,0	2,80
ER07	35	160	73	26	12,5	62,5	3,80

LØFTEØJER MED PRESNING - KLASSE 8, GULMALET

MASTER LINK RECESSED - GRADE 80, YELLOW PAINTED

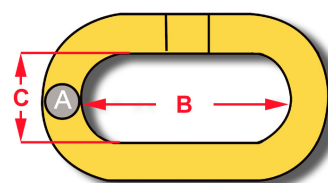

Best. nr.	Kædestørrelse	A	B	C	Swl	Brud	Vægt
Order no.	Chain size	A	B	C	Swl	Break load	Weight
	Enkelt rk./Single leg	mm	mm	mm	Tons 1:4	Tons	Kg.
8646226	(WA180) 6/7	13	110	60	1,60	6,40	0,32
8646227	(WA181) 8	16	110	60	2,24	8,96	0,60
8646317	(WA182) 10	18	135	75	3,20	12,80	0,80
8646416	(WA183) 13	22	160	90	5,00	20,00	1,50
8646515	(WA184) 16	26	180	100	8,00	32,00	2,32
8646516	(WA185) 18	32	200	110	11,20	44,80	4,25